

MAIN FLOOR

581 SQ. FT.

9' CEILING HEIGHT

UPPER FLOOR

581 SQ. FT.

8' CEILING HEIGHT

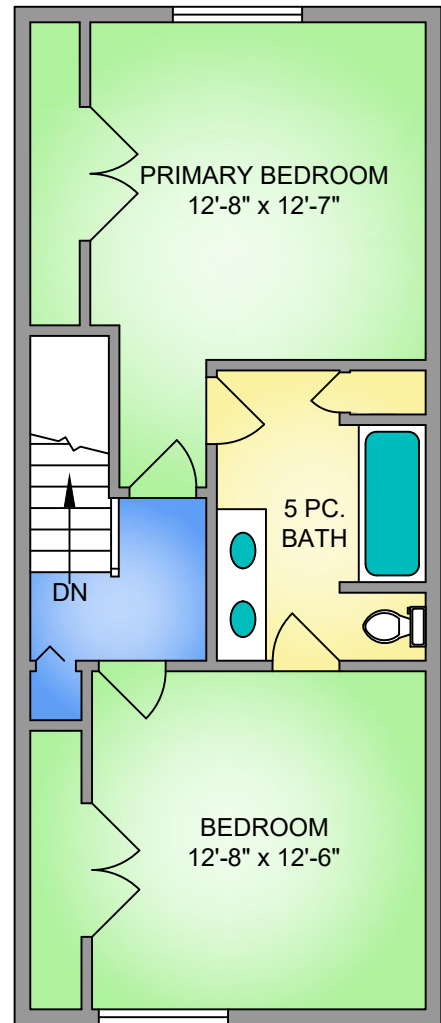

NORTH

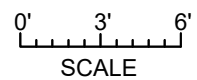
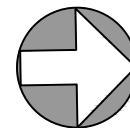

#16 - 1893 PROSSER ROAD
MAY 21, 2021
PREPARED FOR THE EXCLUSIVE USE OF THE LYNN TEAM
PLANS MAY NOT BE 100% ACCURATE, IF CRITICAL BUYER TO VERIFY.

FLOOR	AREA (SQ. FT.)		
	FINISHED	GARAGE	DECK / PATIO
MAIN	581	301	233
UPPER	581	-	-
TOTAL	1162	301	233